

REV.	DESCRIPTION	DATE
A	RELEASE	May 22, 2013

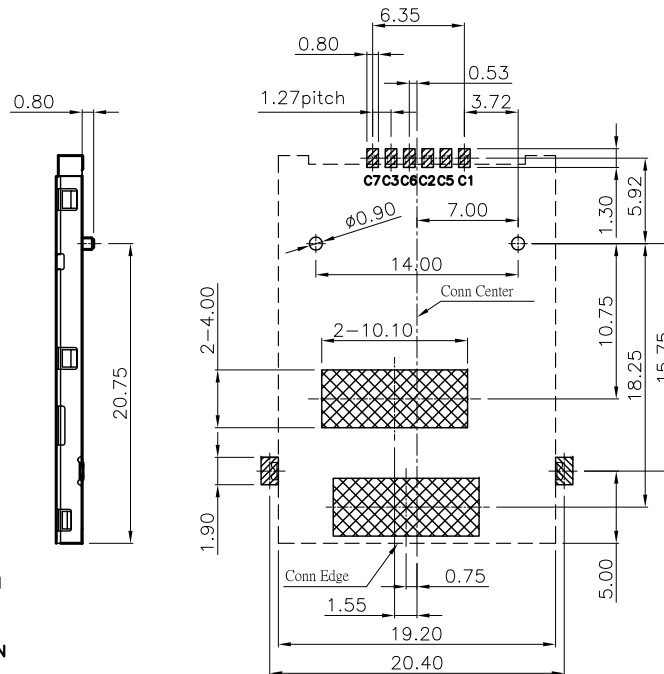
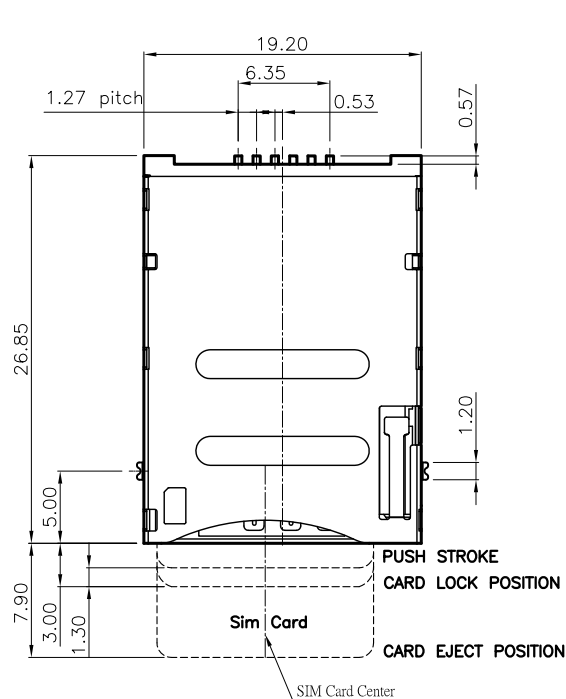

- PAD AREA
- KEEP AREA
- KEEP OUT AREA

RECOMMEND PCB LAYOUT
 TOLERANCE: ± 0.05
 TOP VIEW

MATERIALS

- HOUSING : THERMOPLASTIC (UL 94V-0).
- TERMINAL : COPPER ALLOY, PLATING SEE TABLE.
- SHELL : SUS.

SPECIFICATION

- CURRENT RATING : 1.5 A. MAX.
- DIELECTRIC WITHSTANDING VOLTAGE : 500V AC R.M.S. FOR 1 MINUTE.
- INSULATION RESISTANCE : 100M Ω MIN.AT 500V DC.
- CONTACT RESISTANCE : 100m Ω MAX.
- OPERATING TEMPERATURE : -40°C TO +85°C.
- MATING CYCLES :5000 INSERTIONS.

PART NUMBER INFORMATION :

5100106-X1107S-X

- SERIES CODE
- SMT 90°
- SMI CARD
- SINGLE TYPE
- NUMBER OF POSITIONS
- R:RoHS
- H:HALOGEN FREE
- FOLLOW NUMBER
- WITH PUSH
- INSERT TYPE
- PLATING SEE TABLE

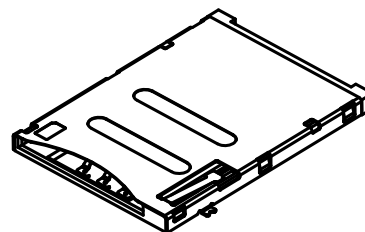
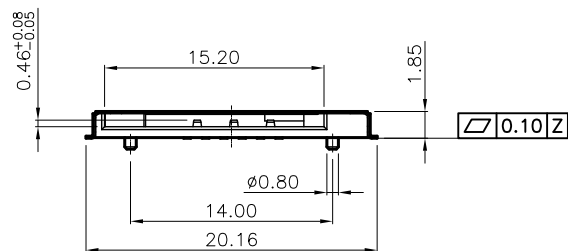

Connector terminal NO.	Pin NO.
Pin 1	VCC:PWR signal and GND
Pin 2	RST:Reset signal
Pin 3	CLK:Clocking signal
Pin 5	GND:PWR signal and GND
Pin 6	VPP:Porgramming Voltage
Pin 7	I/O:Serial date input/output

DESCRIPTION OF PLATING ON TERMINALS			
NO.	EXPLAIN	NO.	EXPLAIN
0	GOLD FLASH	3	GOLD 15u"
1	GOLD 5u"	4	GOLD 20u"
2	GOLD 10u"	H	G/F + TIN

TOLERANCE .0= ± 0.25 .00= ± 0.15 .000= ± 0.05 ANG.= $\pm 3^\circ$	DRAWER 21 CHECK 21 APP'D 21/1/13	INMO 东莞市英墨电子有限公司 INMO Electronics Co.,Ltd
UNITS : mm	PRODUCT SPEC. —	
SCALE NONE SIZE A6 SHEET 1 OF 1 REV. A	NAME SIM CARD PUSH PUSH (6PIN) H=1.85	
		DRAW NO. R5100106-X1107S-X